

The Evans, Opp. Panchlok Homes
Nr. Green Aura, Tragad Road
Chandkheda, Ahmedabad-382424
E : sales@tri-group.in

 **635 9090 333**

PR/GJ/GANDHINAGAR/GANDHINAGAR/GANDHINAGAR MUNICIPAL CORPORATION/
MN62AA09962/060622 / WWW.GUJRERA.GUJARAT.GOV.IN

ARCHITECT
KARTIK BIJLANI ASSOCIATES

STRUCTURE CONSULTANT
P-CUBE CONSULTANTS LLP



TRIGROUP



Constructing Marvels

THE
EVANS

The thoughtfully planned, positioned & designed residential project The Evans propose to offer the signature style living to all its residents. Being situated in a well-connected location, it will offer the benchmarking lifestyle amenities. Quality construction of the project stands tall while its meticulously planning takes care of comfort for all.





THE
EVANS

SMART LIFESTYLE
DESIGNED TO ELEVATE
YOUR ART OF LIVING



THE
EVANS

QUALITY CONSTRUCTION
MEETS NATURE TO
GIVE YOU LIFE THAT'S
GRACEFUL & PEACEFUL



AMENITIES

IMPECCABLE INDOOR AMENITIES
OUTSTANDING OUTDOOR AMENITIES



MULTIPURPOSE HALL



LANDSCAPE GARDEN



SENIOR CITIZEN AREA



CHILDREN PLAY AREA



INFORMAL SITOUT



JOGGING TRACK



GYM



YOGA DECK



CLUB HOUSE



TENNIS BADMINTON COURT



WELL DESIGNED ENTRANCE FOYER



DROP OFF ZONE



CCTV CAMERA



FIRE SAFETY



SOLAR PANEL

TAKE AN ENTRY TO THE LIFESTYLE THAT OFFERS THE BEST OF VIEWS

THE EVANS



LET THE EQUIPPED GYM
IN YOUR RESIDENTIAL PREMISES SHOO
AWAY ALL EXCUSES



GROUND FLOOR





TYPICAL FLOOR



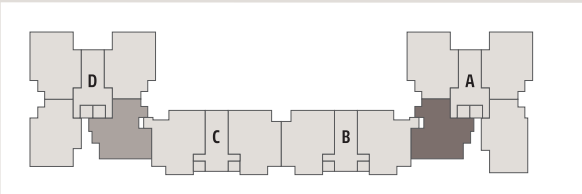
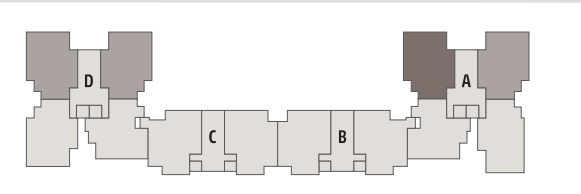

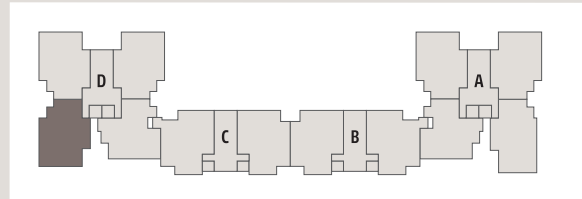
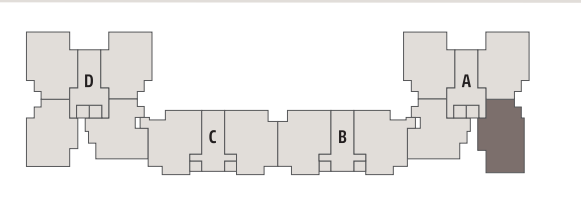

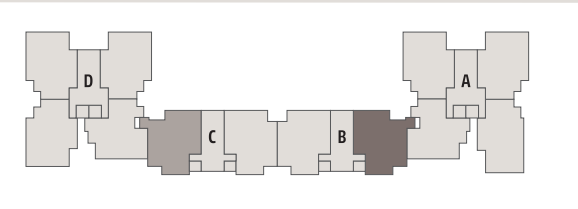
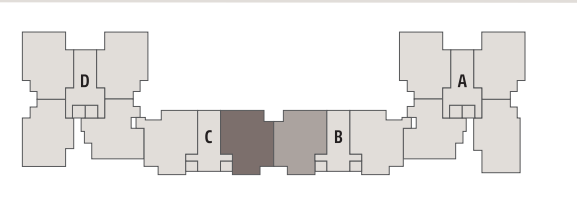



THE
EVANS

BASK IN THE ASSOCIATION OF
CONVENIENCE & COMFORT



SPECIFICATIONS

STRUCTURE

Earthquake resistant R.C.C. frame structure as per structural engineer's design

FLOORING

Vitrified tiles flooring in all rooms

KITCHEN

Granite platform with S.S. sink
Glazed tiles dado up to lintel level
Provision for R.O. point with required electrical & plumbing point

BATHROOMS/TOILET

Anti-skid flooring
Glazed tiles dado up to lintel level
Branded sanitary ware fittings

DOORS & WINDOWS

Laminated flush doors with wooden frame
Premium quality aluminium section with jamb

WASH AREA

Anti-skid flooring
Provision for washing machine with electrical and plumbing point

ELECTRIFICATION

Concealed copper wiring with M.C.B / E.L.C.B.
Branded modular switches with sufficient electrical points in all rooms
Electrical point for A.C. in drawing room and bedrooms

PLUMBING

Branded U.P.V.C. pipes for regular water supply
Branded C.P.V.C. pipes for hot water supply
Branded P.V.C pipe for drain

TERRACE.

Open terrace with water proof treatment

PLASTER & PAINTS

Inside : Single coat mala plaster with wall putty finish
Outside : Double coat mala plaster with texture or exterior paint for attractive elevation



RULES & REGULATIONS • Stamp Duty, Registration Charges, Legal Documentation Charges, GST, Maintenance Deposit, Torrent Charges and any other charges shall be borne by buyer separately. • Any Additional charges of duties levied by government / local authority during or after the completion of the project will be borne by the buyer. • Internal changes shall be done with prior permission and shall be charged in advance. • Changes in external elevation shall not be permitted. • All rights reserved by the developer for alteration / modification / improvement in specification / changes in dimensions and planning shall be binding to all. • Business practices leading to pollution, causing material damage to the building or members are not allowed in the premises. • Irregular payments may attract interest or lead to cancellation of booking/s.

DISCLAIMER • This brochure and model are not part of any legal documents. • All dimensions / measurement given are unfinished and approximate. • The photographs & artistic impressions are for references only. Actual building may vary from the representations mentioned in the brochure. • This is not an advertisement within the meaning of RERA. This is not an offer, invitation or commitment of any nature. Receipts are advised to appraise themselves of the necessary and relevant information of the project prior to making any purchase decisions. All the specifications of the flat shall be as per the final agreement between the parties. *Subject To Gandhinagar Jurisdiction • T&C Applicable*



LOCATION QR

